



Conference Room Information

Building 1 – Level 2

Confluence #255A

- 12' X 12'
- 150 square feet
- 6 person boardroom
- flat-panel television screen, telephone

Global #201

- 39' X 36'
- 1426 square feet
- 60 classroom; 96 theater
- computer, projector, screen, podium, flat-panel televisions (3), webcam, videoconferencing, built-in catering credenza

Collaboration #269C

- 13' X 11'
- 152 square feet
- 6 person boardroom
- computer, flat-panel television screen, telephone, whiteboard

Vision #252

- 18' X 13'
- 270 square feet
- 8 person boardroom
- computer, flat-panel television screen, Polycom conference phone, whiteboard

Innovation #241

- 36' X 25'
- 868 square feet
- 30 classroom; 56 theater
- computer, flat-panel television, whiteboard

Imagination #249

- 36' X 25'
- 868 square feet
- 30 classroom; 56 theater
- computer, flat-panel television, whiteboard

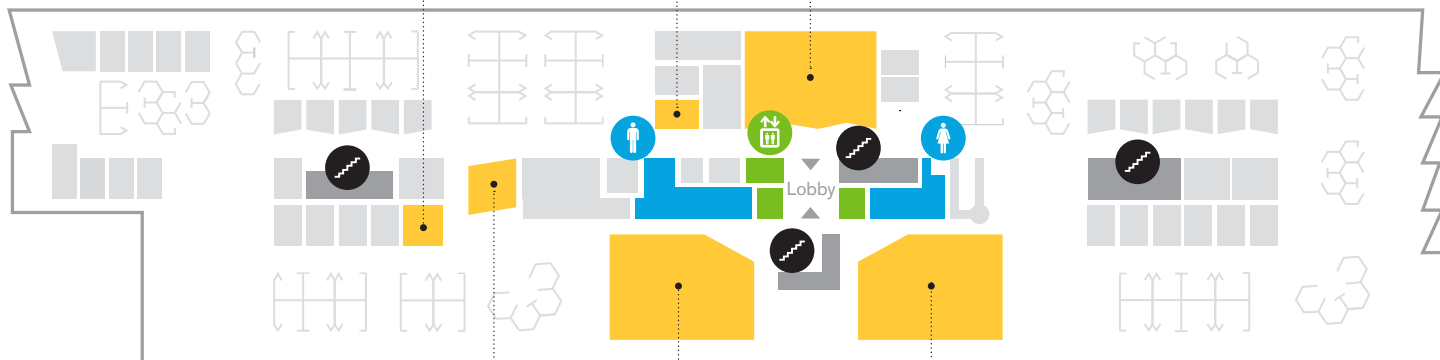
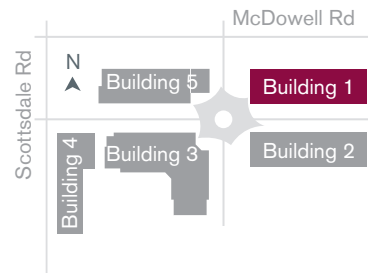

*** ALL ROOM DIMENSIONS ARE APPROXIMATE.**



Conference Room Information

Building 1 – Level 3

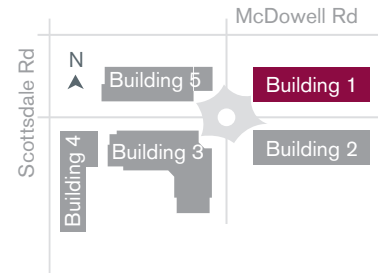

Endeavor #352

- 18' X 13'
- 287 square feet
- 10 person boardroom
- computer, flat-panel television, webcam, whiteboard, Polycom conference phone

Alliance #365

- 36' X 25'
- 713 square feet
- 24 classroom; 45 theater
- computer, flat-panel televisions (2), conference phone, whiteboards (2), videoconferencing equipment

Ingenuity #301

- 39' X 36'
- 1416 square feet
- 60 classroom; 92 theater
- computer, projector, screen, flat-panel televisions (2), teacher workstation, whiteboard

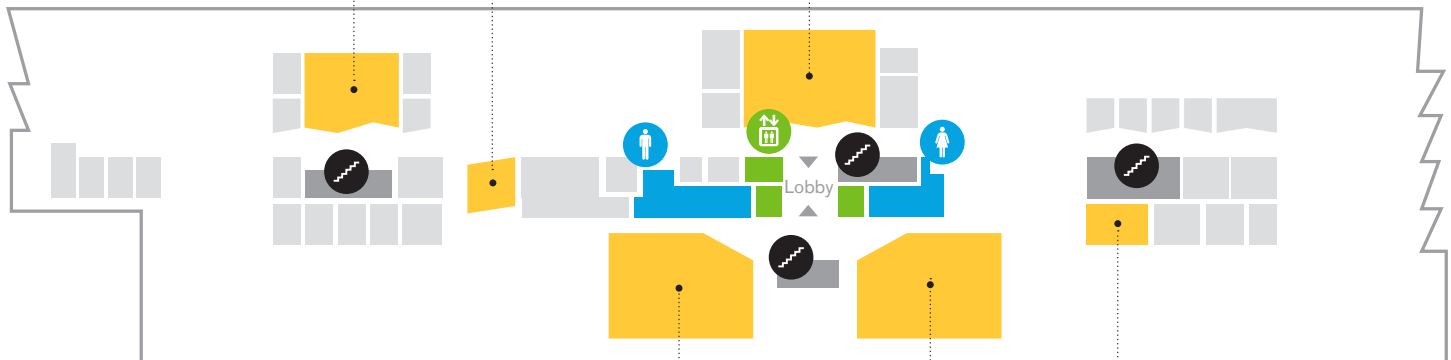

Discovery #349

- 46' X 25'
- 1108 square feet
- 40 classroom; 56 theater
- computer, Promethean board, flat-panel television, whiteboard

Acceleration #335D

- 19' X 12'
- 251 square feet
- 8 person boardroom
- computer, flat-panel television screen, conference phone, whiteboard

Exploration #341

- 46' X 25'
- 1105 square feet
- 30 classroom
- computer, projector, telephone, whiteboard, teacher workstation

*** ALL ROOM DIMENSIONS ARE APPROXIMATE.**



Conference Room Information

Building 3 – Level 1

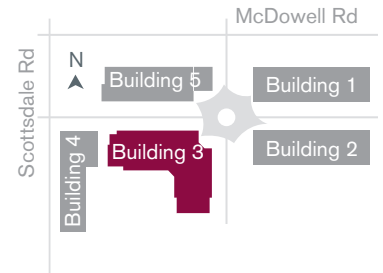

Synergy I & II #130 & 135

- 93'10" X 50'
- 4649 square feet
- 370 theater; 180 classroom
- catering prep room available

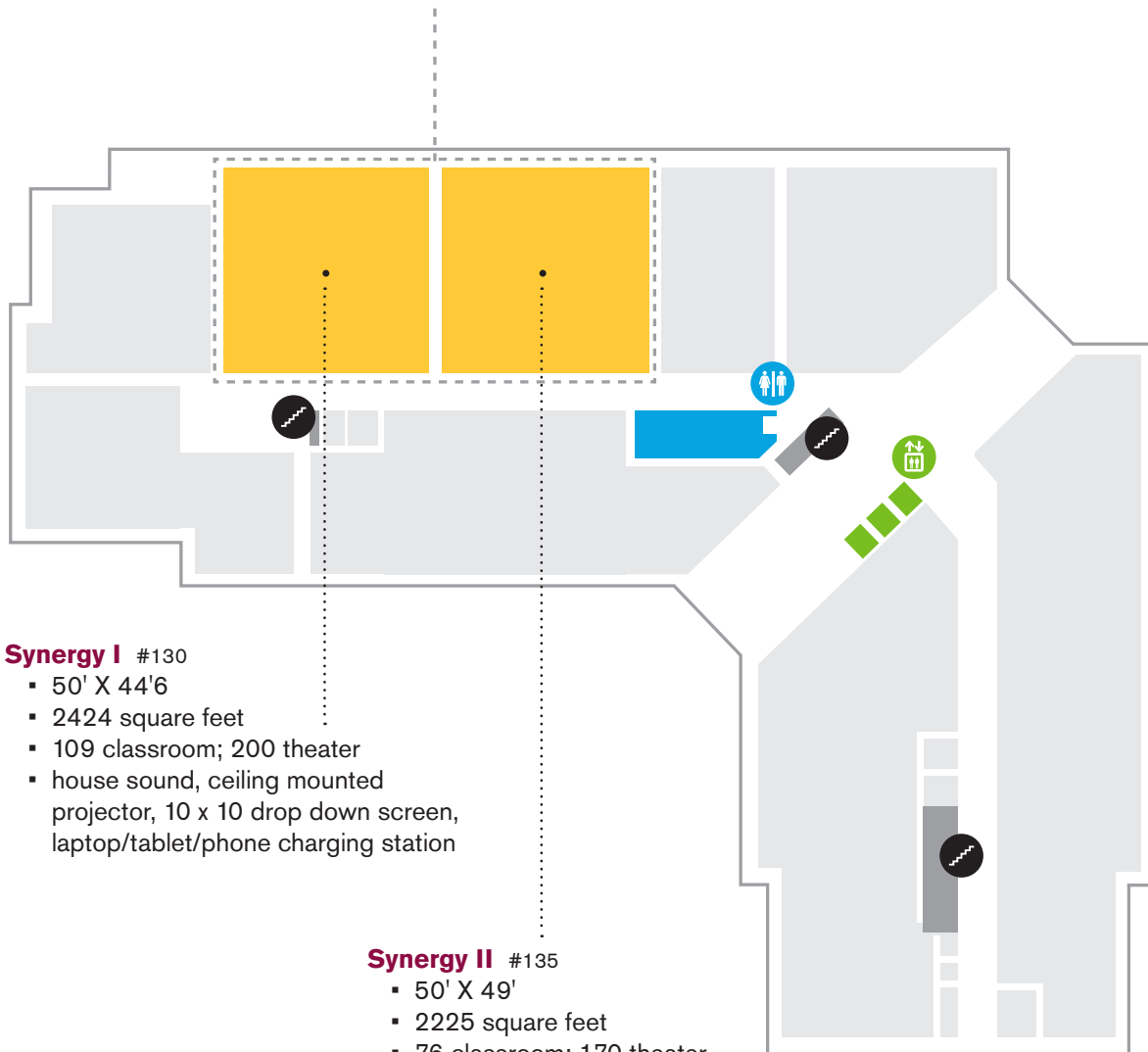

Synergy I #130

- 50' X 44'6"
- 2424 square feet
- 109 classroom; 200 theater
- house sound, ceiling mounted projector, 10 x 10 drop down screen, laptop/tablet/phone charging station

Synergy II #135

- 50' X 49'
- 2225 square feet
- 76 classroom; 170 theater
- house sound, ceiling mounted projector, 10 x 10 drop down screen, laptop/tablet/phone charging station

*** ALL ROOM DIMENSIONS ARE APPROXIMATE.**